

FPX 34 Artisan Face

PART NUMBERS

• Charcoal: 95300630

• Patina Bronze: 95300629

COMPATIBILITY

• DVL Insert

ITEMS NEEDED FOR ASSEMBLY

• 3/8" Nutdriver

• Adjustable Wrench

Hand-Rubbed Patina Finishes

The optional patina finish is hand applied by a skilled artisan to permanently alter the metal colors and texture of the face. Each face is individually hand-polished and fired in an oven which imparts unique color subtleties with no two finishes alike. The patina finish on your face is a "living" color and will age and antique over time. Enjoy the timeless, rich luster of your beautiful new face.

PACKING LIST

- Face
- Four 10-24 Nuts
- Four 1/4-20 Bolts
- One Left & One Right Mounting Bracket
- Pull Tool (for opening the control door)

INSTALLATION INSTRUCTIONS

- ! Turn the gas control valve to "OFF" prior to conducting any service.
- 1 The log set, coals, and glass must be installed prior to installing the face (on the DVL Insert, the panels must be installed as well).
- 2 Install the face onto the fireplace (follow the directions to the right).

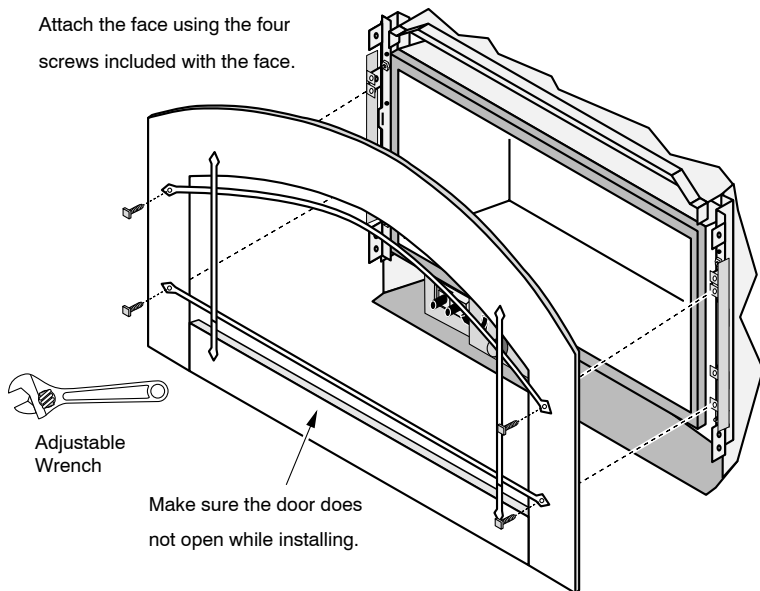
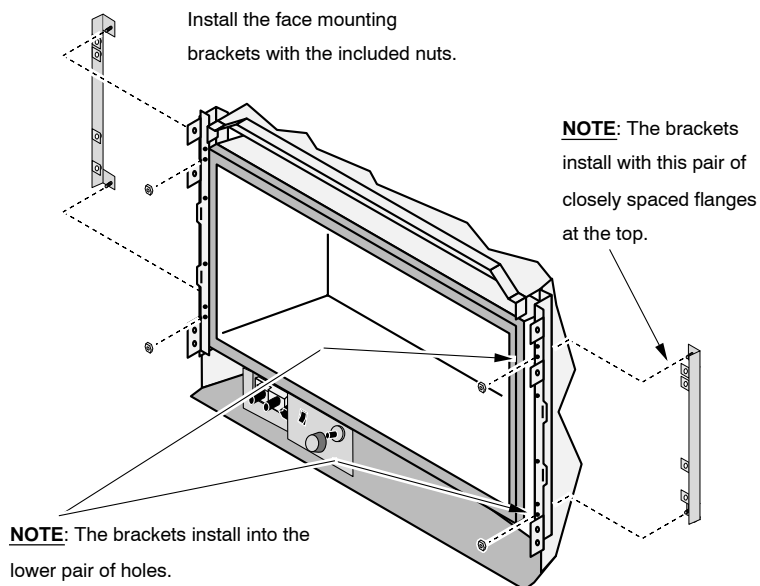

FPX 34 Artisan Face

OPENING THE CONTROL DOOR

! The face becomes extremely hot during operation. To avoid burns, use the included pull tool to open the control door. Make sure the homeowner knows how to use this tool.

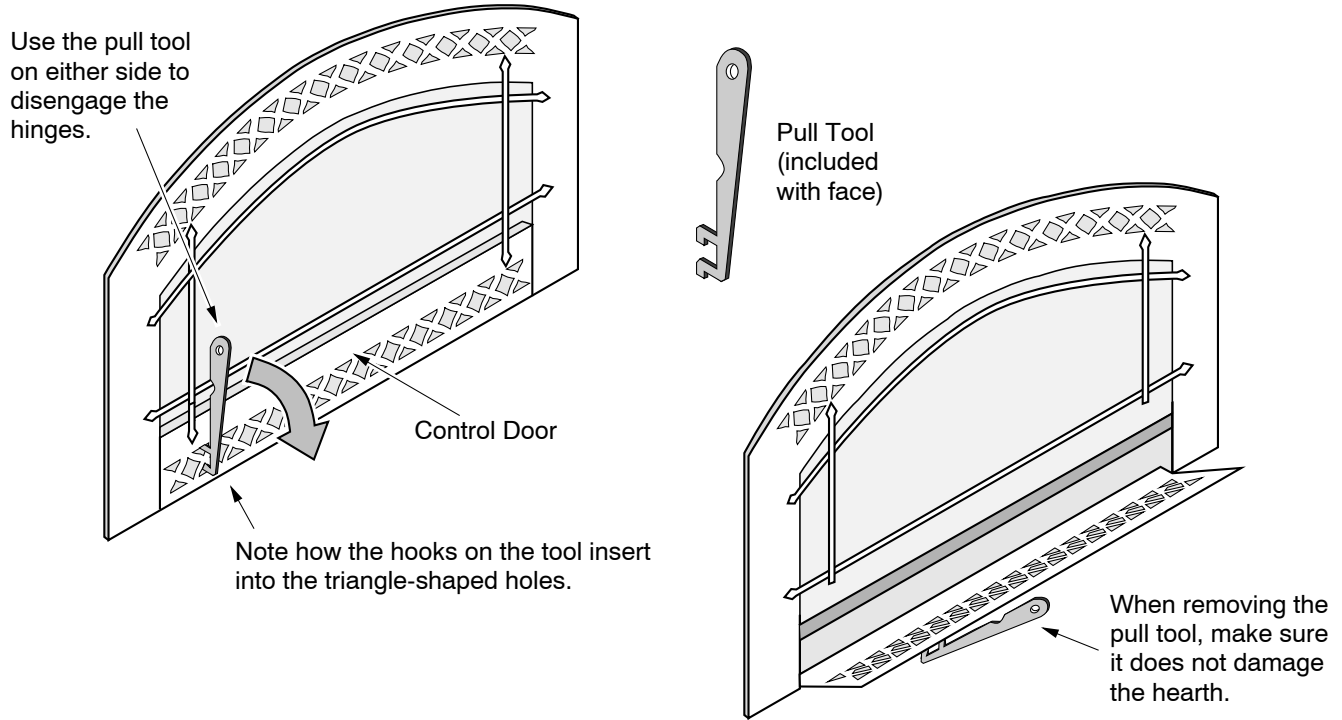

ADJUSTING THE CONTROL DOOR HINGE

The control door hinge is adjusted at the factory. It can be adjusted if required. The illustrations below detail these adjustments.

Bullet Catch

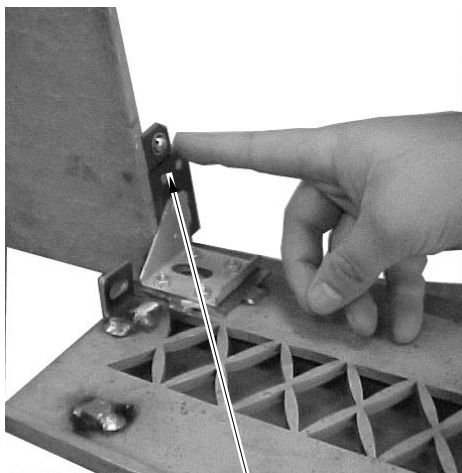

This bullet-shaped device holds the control door upright. To tighten or loosen the catch, simply rotate it (it is threaded inside the assembly).

Back of Face (with face removed)

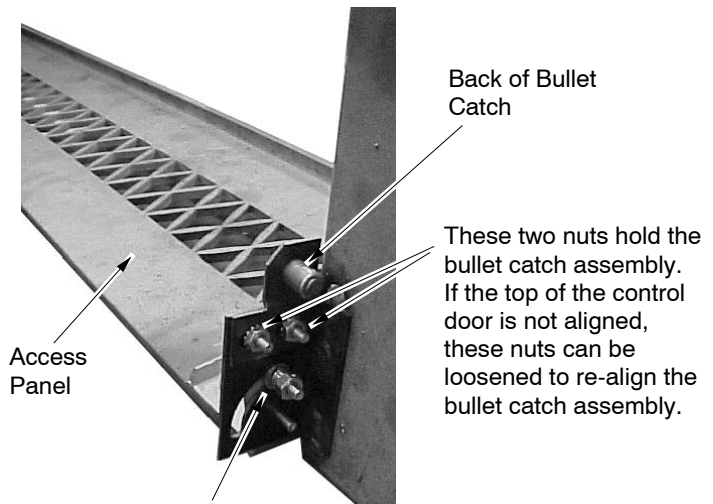

Adjust this nut to tighten or loosen the friction of the hinge.