



TRAVIS INDUSTRIES  
HOUSE OF FIRE

# 430 GSR2 Insert - Cheat Sheet

The 430 GSR2 has several new features and characteristics that require special attention during installation and set-up. This unit uses the new GreenSmart 2 system. Refer to the owner's manual for full details.

## GreenSmart™ 2

This heater uses the GreenSmart™ 2 components from SIT. These components function in a near identical fashion to the previous GreenSmart™ 1 components. The primary differences are:

- The accent light now has dimming capability built into the remote.
- The pilot may be switched from intermittent (IPI) to standing pilot from the remote.

## Remote Control / Pilot Warnings



Installing batteries in the battery holder or connecting the appliance to power may automatically initiate the CPI pilot mode, resulting in a lit pilot flame. Do not place combustibles in the firebox.

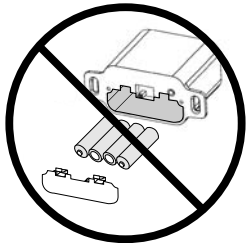

### **KEEP BATTERIES AND COVER INSTALLED AT ALL TIMES**

The remote control system requires the batteries and battery cover to remain in place at all times. Once the batteries or cover are removed, the system may re-start in standing pilot mode. If this occurs when the heater is in Remote Mode, you will not be able to turn the heater off manually from the battery box. If you need to replace dead batteries, make sure to **turn the appliance off** before removing the batteries.

**NOTE:** If the batteries go dead, the system will operate normally as long as household power (120v AC) is present.

## If using LP (Propane)

A conversion kit is required if using propane with this heater (sku 94400999 – GSR Stepper Motor Kit).

## Additional Items

- **Remove and Discard the Shipping Brackets (and screws) on Each Side of the Insert**  
The shipping brackets protect the insert during shipping . See surround panel instructions for details.
- **Glass Tool is Attached to the Insert, Inside the Right Convection Chamber**  
This insert uses a glass tool to remove the glass frame. It is shipped inside the right convection chamber, attached with a screw. See the photos below for glass frame removal. See manual for details.



- **This Insert Requires a 1/2" Hearth 1-3/4" Deep** See installation manual for details.
- **If Using Tall Vent (over 25') You Must Open the Diffuser Before Attaching Vent**  
The diffuser must be adjusted before attaching the vent (it is attached to the vent connector and is concealed once the vent is installed). See owner's manual for details.
- **Vent Kit "F" 96200330 May Be Used With This Insert**  
The co-linear 3" vent kit works with this insert. See manual for details.
- **Power Cord Exits Behind Surround Panel**  
The power cord ships attached to the side of the insert. It may be re-routed to the front (exits between face and surround panel) by disconnecting the strain relief and molex connector.



## 430 GSR2 Insert - Cheat Sheet

### **HAVE YOUR ACCESSORIES ON HAND WHEN INSTALLING THIS INSERT**

This insert requires the following accessories:

- Media Kit (logs)
- Firebacks
- Surround Panels
- Face

These accessories are required to ensure correct and safe operation. Do not operate the appliance without the firebacks in place.

### **ORDER OF INSTALLATION**

When setting up the insert, you will need to follow a specific order of installation to optimize installation time. Failure to have all of the accessories available at the time of installation will delay installation and may lead to unnecessary disassembly of components.

1. Run gas line to the fireplace
2. Remove the glass frame.
3. Run vent through fireplace chimney. On larger fireplaces, the vent connector may be left in place. For smaller fireplaces, remove the vent connector. See "Vent Connector Removal and Installation" for details.



**INSTALLATION WARNING:** If using a tall vent (over 25') – you must open the diffuser before attaching the vent. See "Diffuser Adjustment" for details.



**INSTALL THE LIGHT SHIELD (ALL FACES EXCEPT SHADOWBOX).** The light shield (shipped with the face) prevents light from exiting the upper grill area. Install this prior to placing the insert.

4. Place insert into position and attach the gas line and vent.
5. Remove the burner.  
**NOTE:** If using propane (LP), convert the appliance at this time.
6. Install the firebacks.
7. Replace the burner.
8. Install the media (logs - see instructions included with the media).
9. Install the surround panel (see instructions included with surround panel).
10. Replace the glass.
11. Install the face (see instructions included with the face).
12. Follow the instructions under "Finalizing the Installation."